

WEST SUSSEX COUNTY COUNCIL
((CRAWLEY BOROUGH) (PARKING PLACES AND TRAFFIC REGULATION)
(CONSOLIDATION) ORDER 2010)
(THE BIRCHES AMENDMENT) ORDER 2016

CRAWLEY: LOCATION OF WAITING RESTRICTIONS

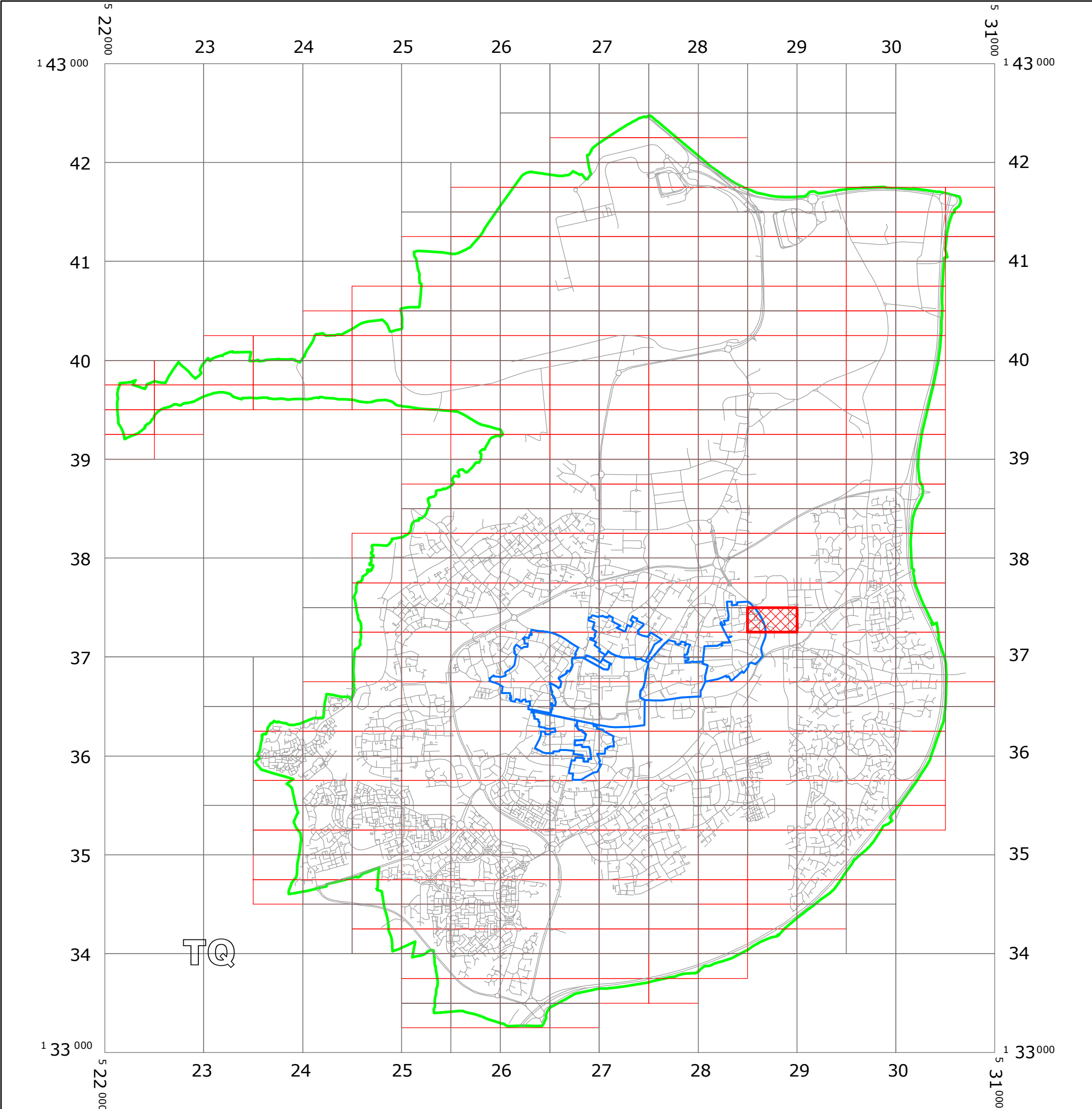

KEY:

OS TILE GRID

PARKING TILE GRID

LOCATION OF WAITING RESTRICTIONS

PARISH BOUNDARY

CONTROLLED PARKING ZONE BOUNDARY

ROAD NETWORK



West Sussex County Council
Communities & Infrastructure
The Grange
Tower Street
Chichester
West Sussex
PO19 1RH

WEST SUSSEX COUNTY COUNCIL
((CRAWLEY BOROUGH) (PARKING PLACES AND TRAFFIC REGULATION)
(CONSOLIDATION) ORDER 2010)
(THE BIRCHES AMENDMENT) ORDER 2016

LOCATION OF WAITING RESTRICTIONS



Reproduced from or based upon 2013 Ordnance Survey material with permission of the Controller of HMSO
(c) Crown Copyright reserved. Unauthorised reproduction infringes Crown copyright and may lead to
prosecution or civil proceedings West Sussex County Council Licence No. 100023447

SCALE: 1:40,000
DATE: 21/03/2016

Key for Waiting Restrictions

All areas over which the provision of the orders apply are defined by the shaded areas as shown on the following plans plus a contiguous area not indicated on the plans of verge and/or footway between the carriageway edge and the highway boundary. The plans in this schedule are based upon grid references of the Ordnance Survey National Grid defined by the OSGB 36 triangulation.

Prohibition of waiting at any time

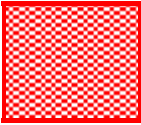
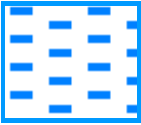
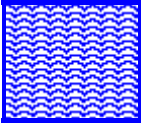
101		check	No waiting at any time	161		pat063	No waiting 9:00am-5:00pm Mon-Fri except bank holidays
105		smallwave2	No waiting 8.00am-6.00pm any day				

Residents Parking

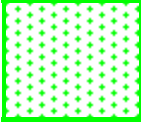
516		usgs721	Residents' and Visitors' permit holders only 9.00am-5.00pm Mon-Fri except bank holidays
-----	---	---------	--

Shared Residents Parking & Free Limited Waiting

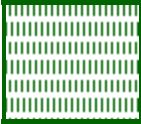
623		pat038	Residents' and Visitors' permit holders and Limited waiting for 2hrs No return within 2hrs for non-permit holders 9.00am-5.00pm Mon-Fri except bank holidays
-----	---	--------	---

Free Limited Waiting

731		usgs717	Waiting limited to 2hrs No return within 2hrs 8.00am-6.00pm Mon-Fri
-----	---	---------	--

Specified Vehicles

830



check

Disabled persons vehicles at any time



Boundary of Controlled Parking Zone



District Boundary

WEST SUSSEX COUNTY COUNCIL
((CRAWLEY BOROUGH) (PARKING PLACES AND TRAFFIC REGULATION)
(CONSOLIDATION) ORDER 2010)
(THE BIRCHES AMENDMENT) ORDER 2016

West Sussex County Council in exercise of their powers under Sections 1 (1) 2 (1) and (2), 4 (2), 45, 46, 49 and 53 and Part IV of Schedule 9 of the Road Traffic Regulation Act 1984 "the Act" as amended and of all other enabling powers and after consultation with the chief officer of police in accordance with Part III of Schedule 9 to the Act hereby make the following Order:-

1. This Order shall come into operation on the 21st day of March 2016 and may be cited as "West Sussex County Council ((Crawley Borough) (Parking Places and Traffic Regulation) (Consolidation) Order 2010) (The Birches Amendment) Order 2016."
2. The "West Sussex County Council (Crawley Borough) (Parking Places and Traffic Regulation) (Consolidation) Order 2010" is hereby amended by the deletion from it of the plan specified in the First Schedule to this Order and the substitution of the plan attached in the Second Schedule to this Order.

FIRST SCHEDULE
Plan to be deleted

TQ2837SEN (Sheet No. 3)

SECOND SCHEDULE
Plan to be substituted
(as attached)

TQ2837SEN (Sheet No. 4)

THE COMMON SEAL of WEST SUSSEX
COUNTY COUNCIL was hereto affixed

the fifteenth day of MARCH 2016
in the presence of:

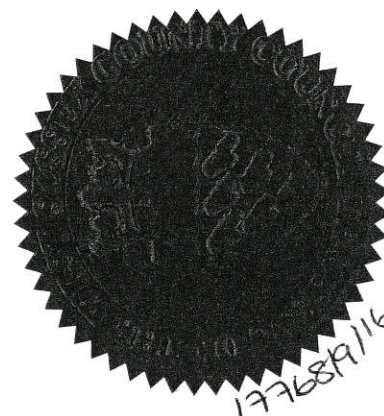

Authorised Signatory

)
)
)
) (L.S)
)
)
)
)



04/08 DELEGATED AUTHORITY

I HEREBY CERTIFY THIS TO
BE A TRUE COPY OF THE
ORIGINAL DOCUMENT

.....
Authorised Officer
WEST SUSSEX COUNTY COUNCIL

I HEREBY CERTIFY THIS TO
BE A TRUE COPY OF THE
ORIGINAL DOCUMENT

.....
Authorised Officer
WEST SUSSEX COUNTY COUNCIL

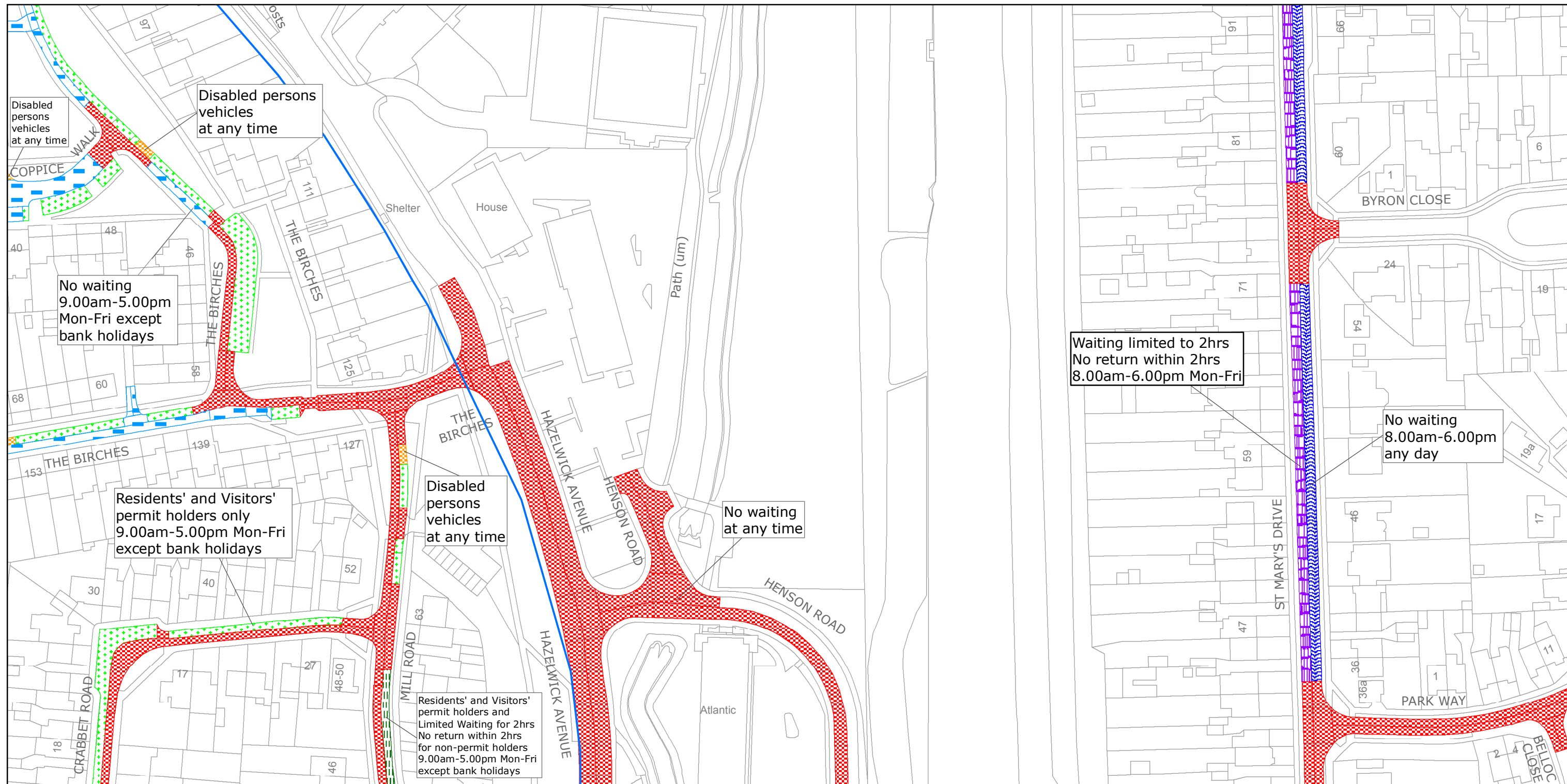

West Sussex County Council
Highways & Transport
The Grange
Tower Street
Chichester
West Sussex
PO19 1RH

CRAWLEY BOROUGH: POUND HILL NORTH AND THREE BRIDGES WARDS

WAITING RESTRICTIONS

Reproduced from or based upon 2013 Ordnance Survey material with permission of the Controller of HMSO (c) Crown Copyright reserved.
Unauthorised reproduction infringes Crown copyright and may lead to prosecution or civil proceedings West Sussex County Council Licence No. 100023447

TILE REF NO:
TQ2837SEN

SHEET ISSUE NO 4
SHEET ACTIVE FROM - 21/03/2016



SCALE:
1:1250
at A3 size